

Internal used only



Veta 5/ Veta 3

Veterinary Anesthesia Machine

Redefining Animal Anesthesia Machine





Electronically driven and controlled, no drive gas needed

Sidestream CO₂ monitoring optional

Integrated breathing circuit

reminder of gas filter canister replacement

VS intelligent ventilation mode, TV down to 5mL

8-inch capacitive touch screen

High-precision vaporizer

Oxygen generator tray optional



Anesthesia safety is always the first concern for veterinarians and pet owners. But it is facing higher requirements and new challenges nowadays.

The Veta series anesthesia machine introduces cutting-edge technology, combined with advanced clinical practice. It brings a brand new working experience of veterinary anesthesia with its intelligent ventilation mode and integrated design concept, to ensure the safety of animals and veterinarians.

Safety Renovating

Intelligent ventilation mode tailored for animals

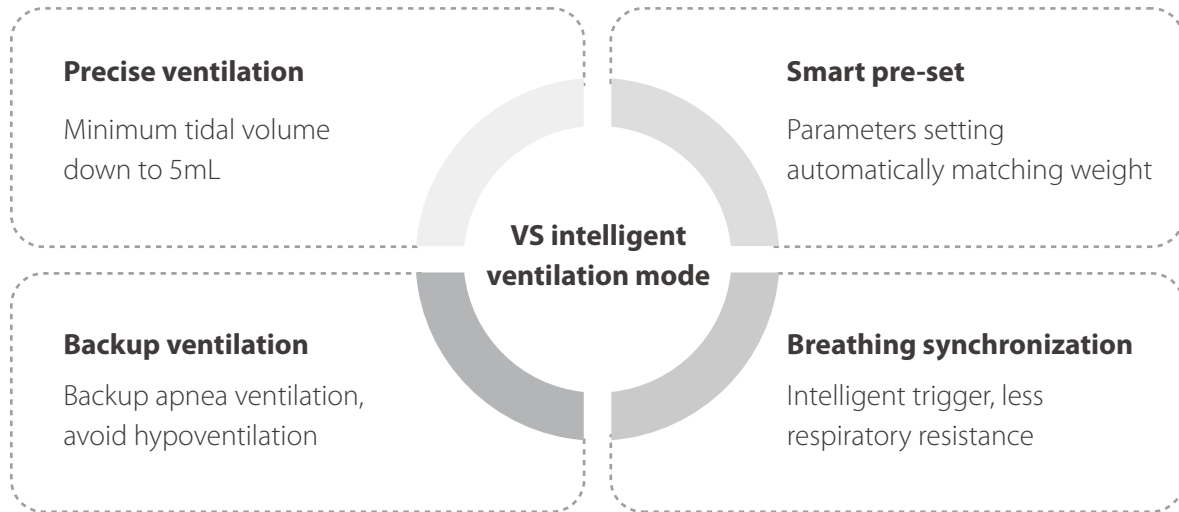

Complete display of patient status

- Comprehensive monitoring, complete display of patient status
- Sidestream CO₂ monitoring optional, ensuring safe anesthesia



More security measures

Auto system leak test

- Graphic guidance
- One-key startup

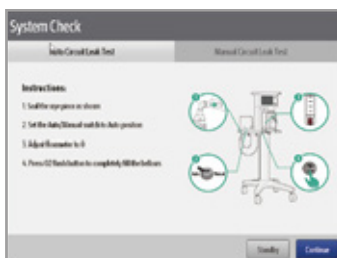

Reminder of gas filter canister replacement

- Accurate calculation of agent absorption, matching different canister
- Automatic reminder to change canister, more worry-free

Multiple types of waste gas scavenging system



Gas filter canister



Passive AGSS



Active AGSS

Form Refreshing

Integrated design, creating a simple and comfortable operating space



Ventilator integrated, no tubes exposed and lower leakage risk



8-inch capacitive touch screen, intuitive operation and efficient interaction



Electronically driven by high-performance turbine, no drive gas needed



Flexible workstation

Multiple mounting solutions for patient monitors, pumps and oxygen generators, improving the space utilization.



Modular Upgrade

Upgrades could be realized from Veta 3 to Veta 5, adding ventilators and providing more possibilities.



